



**BOSCH**

Invented for life

## **Solution 2000 & 3000** Security you can rely on

The Solution 2000 & 3000 alarm panel series from Bosch Security Systems offers you the perfect solution. We've created a security system that has all the technology it needs to identify intruders to your home or small business, without being hard to use. It helps you protect the things you love, providing you with reliable security at your fingertips.

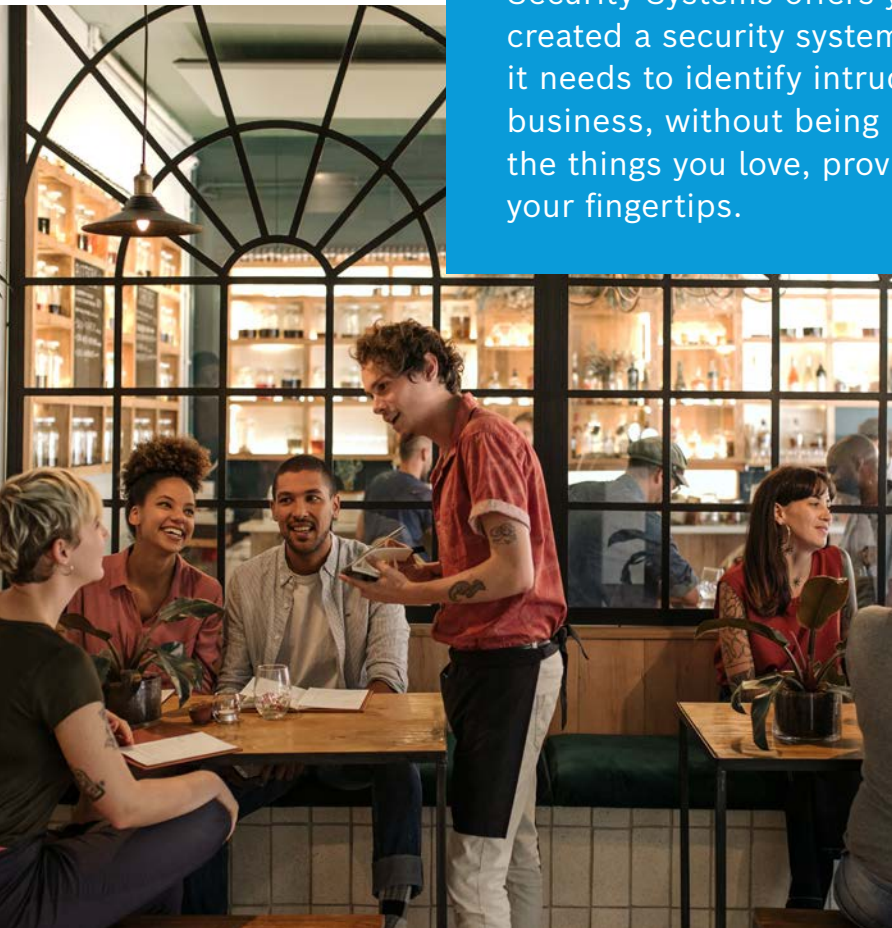



# Solution 2000 & 3000



## Flexibility, agility, and peace of mind.

Supporting up to 8 fully programmable zones on the Solution 2000 and 16 fully programmable zones on the Solution 3000, these intrusion alarm panels are suitable for any home, and even small commercial premises.

With support for up to 4 keypads on both panels and the ability to split into two separate areas, you have the flexibility of one security system that can act as two. Both the house and garage, granny flat, shop, office or warehouse can be covered by the one system at one cost. Each area can even report separately if desired – the perfect arrangement for shared premises such as duplex houses or commercial properties, where more than one business occupies the unit space.



## Ready for the wireless world.

Enjoy easy control of your Solution 2000 intrusion panel with the inclusion of wireless keyfobs that allow you to arm & disarm your system, control external outputs and trigger a panic alarm if you cannot reach the keypad.

Alternatively, experience the true power of wireless with the Solution 3000, which includes the option to integrate with the Bosch RADION range of wireless transmitters. With a growing suite of wireless products such as motion sensors, door & window reed switches, and remote keyfobs, Bosch RADION wireless will create new options for how you manage your home security.



*<sup>1</sup>Bosch RSC+ app requires that the panel include a communications extension module.*

## Users

\* \* \* \* \*



1 Installer Code  
(for both Solution  
2000 & 3000)

+



32 User Codes  
(for both Solution  
2000 & 3000)

+



Key Fobs  
(Up to 21 for Solution  
2000 & 32 for Solution  
3000)



Choose the way you want to use your system, including Touchscreens & wireless remote control options.

## Security... at your fingertips.

Left from work and want to make sure you armed the alarm? Want to open your shop or warehouse door for a delivery? Just load the Bosch Remote Security Control Plus<sup>1</sup> app and you'll have full control of your intrusion panel through your AndroidOS or IOS smartphone.

Arm and disarm your system, trigger outputs to run external devices (like roller doors, air conditioning units, or smart lighting systems), or even check what time the kids left in the morning for school or what time your employees opened up the shop – all of these features and more are built into the intuitive and easy to use Bosch RSC + app.



## System Features



**Outputs**  
(4 programmable outputs +  
16 external outputs)



**Zones**  
(8/16 fully programmable zones.  
8 wired / 16 wired or wireless)



**Stay/Away**  
(Arming options)



**Areas**  
(Create 2 separate alarm areas)



**Entry + Exit  
Warning**  
(Keypad beeps)



**Wireless Devices**  
(16 wireless devices on  
Solution 3000)



**Reporting**  
(256 event history log)



**Automatic  
Arming**

## Other Features

- ▶ Up to 8 RF Repeaters
- ▶ Selectable Reports per User Code
- ▶ Remote Arming
- ▶ LCD Icon, LCD Alphanumeric, and Touchscreen Support
- ▶ Dynamic Battery Test
- ▶ Day Alarm
- ▶ Walk Test Mode
- ▶ Back to Base Reporting
- ▶ Domestic Reporting
- ▶ Dual Entry Timers
- ▶ AC Fail Supervision
- ▶ Phone Line Supervision
- ▶ Zone Lockout

# Solution 2000/3000 System Components

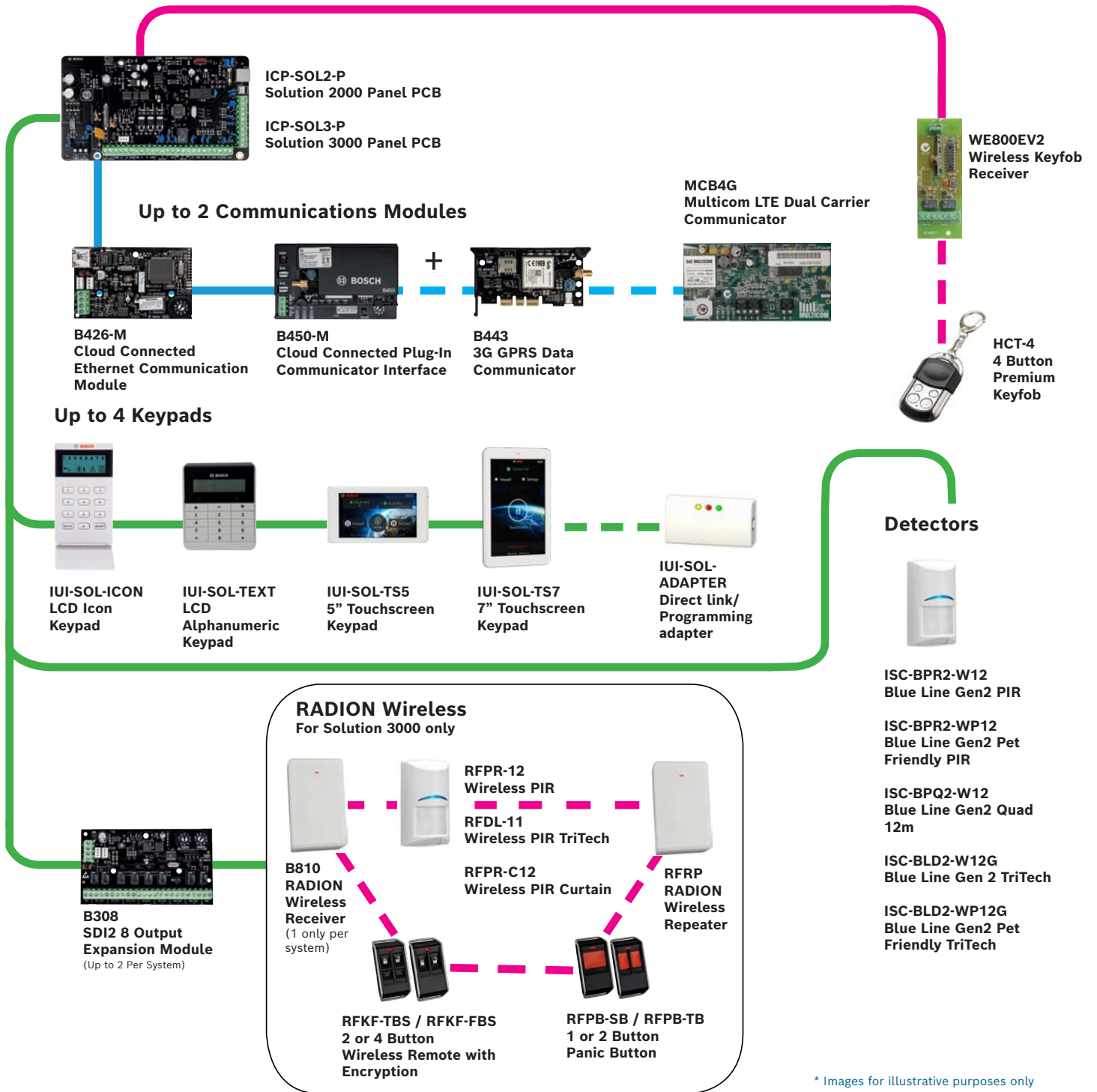

Learn more about  
**Solution 2000 & 3000**

**Bosch Security Systems Pty Ltd**  
For more information please visit  
[www.boschsecurity.com.au](http://www.boschsecurity.com.au)

© Bosch Security Systems 2021  
Modifications Reserved  
Printed in Australia

## Panel Comparison Chart

Product	Solution 2000	Solution 3000
Max Inputs	8	16
Max Outputs	20	20
Wireless Expansion	No	Yes
Max Users	32	32
Max Keypads	4	4
Partitions/Areas	2	2
Event Log	256	256
PSTN	Onboard	Onboard
IP	Module	Module
3G GPRS	Module	Module